

SAFETY & WARNINGS

1. Only for use with compatible 12V and 24VDC constant voltage luminaires.
2. This product is rated for indoor installation and is not protected against moisture.
3. Do not modify product beyond instructions or warranty will be void.

QUICK SPECS / MODELS

DI-RF-WMT-RGBW

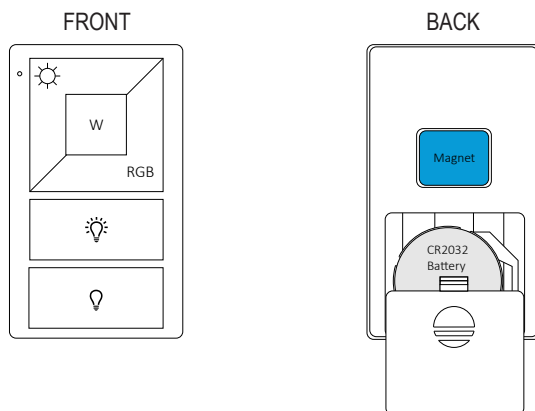

ADDITIONAL TOUCHDIAL COMPONENTS

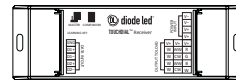

DI-RF-REC-CV-A
TOUCHDIAL Receiver
(Required)

APPROVED LED LUMINAIRES

The TOUCHDIAL RGB(W) Wall Dimmer is compatible with all Diode LED 12V and 24VDC color constant voltage tape lights and fixtures.

TOOLS FOR INSTALL

Mini flat-head
screwdriver

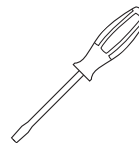

Input	Operating Frequency	Dimensions
3V (CR2032) Battery (Included)	916.5MHz	2.59 x 1.27 x 0.35 in. (L x W x H)

TOUCHDIAL™ RGB(W) Wall Control

INSTALLATION GUIDE

SYNCING INSTRUCTIONS

1 INSTALL TOUCHDIAL RECEIVER SYSTEM

Refer to TOUCHDIAL Receiver Installation Guide.

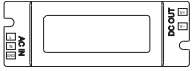

LED Driver

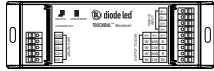

TOUCHDIAL Receiver

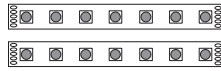

LED Luminaire

2 SYNC TOUCHDIAL CONTROL TO MASTER RECEIVER

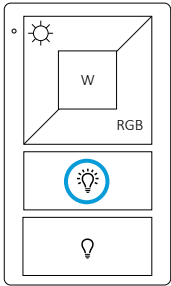

- 2.1** Short press TOUCHDIAL RGB(W) Wall Control Power button.

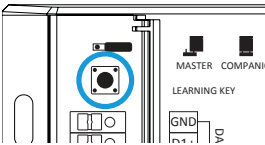

- 2.2** Short press LEARNING KEY button on TOUCHDIAL MASTER receiver.

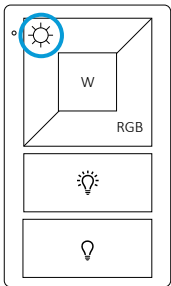

- 2.3** Short press the Increase Brightness button on RGB(W) Wall Control.

- 2.4** Luminaire will flash to indicate pairing.

SYNCING CONT.

SYNCING NOTE

When syncing the TOUCHDIAL RGB(W) Wall Control, the 1st receiver must be set to the MASTER function as outlined below. See the TOUCHDIAL Receiver Installation Guide for more thorough information.

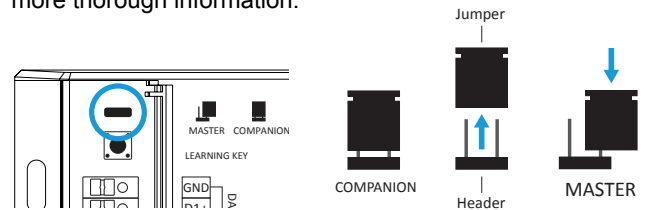

OPERATION

Hold to increase or decrease RGB brightness only.

Hold to increase or decrease White brightness only.

Short press to turn ON.

Long Press to change RGB Color selected.

Short press to turn OFF.

LOOKING FOR SYSTEM DIAGRAMS?

See the TOUCHDIAL RECEIVER (DI-RF-REC-CV-A) Installation guide for SOLID COLOR system diagrams.

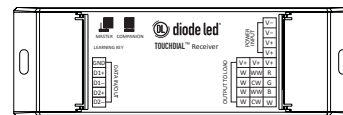

TOUCHDIAL™ RGB(W) Wall Control

INSTALLATION GUIDE

BATTERY REPLACEMENT

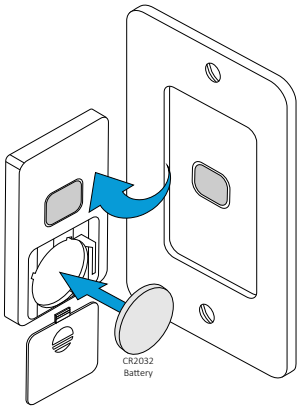

1. Remove Remote from Mount.
2. Open Battery backplate on Remote.
3. Insert new battery.
4. Place Remote back into Mount.

MOUNTING

1. Place Base Mount on surface where desired, ensuring it is level.
2. Screw Faceplate to Mount and surface using included Screws.
3. Place Remote into Faceplate, and connect to Mount using magnet.

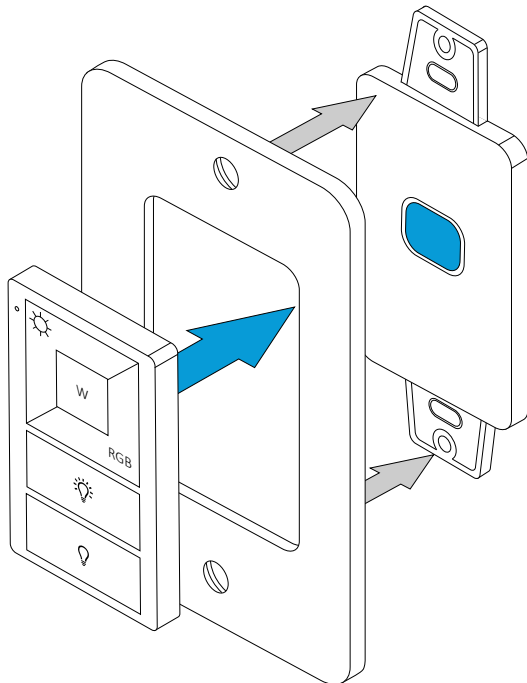

TROUBLESHOOTING

See TOUCHDIAL Receiver Install Guide for more troubleshooting tips.

Symptom	Common Cause
Control won't function	<ul style="list-style-type: none">• Check for dead batteries.• Remote must be turned on for operation.
Master receiver does not sync with remote	<ul style="list-style-type: none">• Ensure function is set to MASTER (1 pin) - See Syncing Note or TOUCHDIAL Receiver Installation Guide.• If still not syncing do following: 1) Turn off main power to receiver and turn back on. 2) Reset receiver by long pressing LEARNING KEY for 5 seconds until LED flashes. 3) Re-sync receiver to control.

ADDITIONAL RESOURCES

TOUCHDIAL RGB(W) WALL CONTROL SPEC SHEET

For full specifications.

TOUCHDIAL RECEIVER SPEC SHEET & INSTALL GUIDE

For full specifications and installation instructions.



Toll Free: 877.817.6028 | Fax: 415.592.1596 | www.DiodeLED.com | info@DiodeLED.com
© 2019 Elemental LED, Inc. All rights reserved. Specifications are subject to change without notice.